

# SHARJAH HEALTHCARE CITY STANDARD COMPONENTS

Room Layout Sheet

Room Name **Store - Files, 10m2**

RLS Room Code **STFS-10-SJ**  
RDS Room Code **STFS-10-SJ**

- COM/1 COMMUNICATION OUTLET - SINGLE
- COM/2 COMMUNICATION OUTLET - DOUBLE
- DP DOOR & DOOR FRAME PROTECTION
- GPO/2 GENERAL POWER OUTLET-DOUBLE
- LS/R LIGHT SWITCH - ROOM
- SK7 TIMBER SKIRTING
- WB WHITEBOARD
- WT WALL TELEPHONE

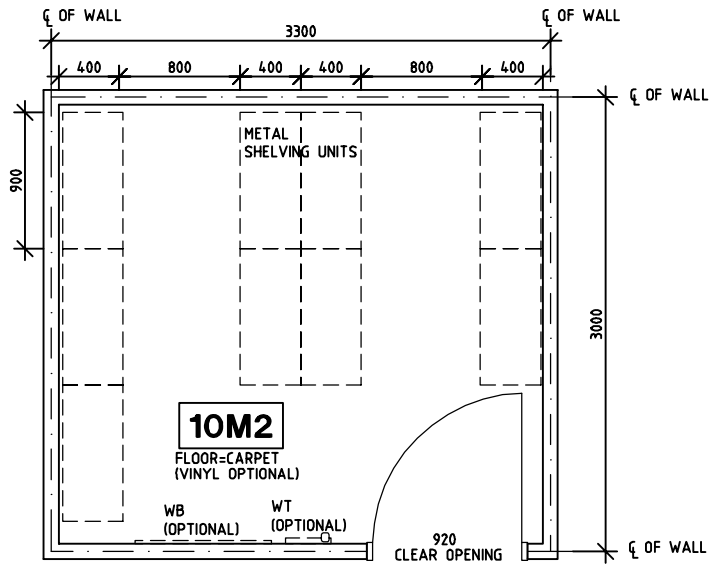
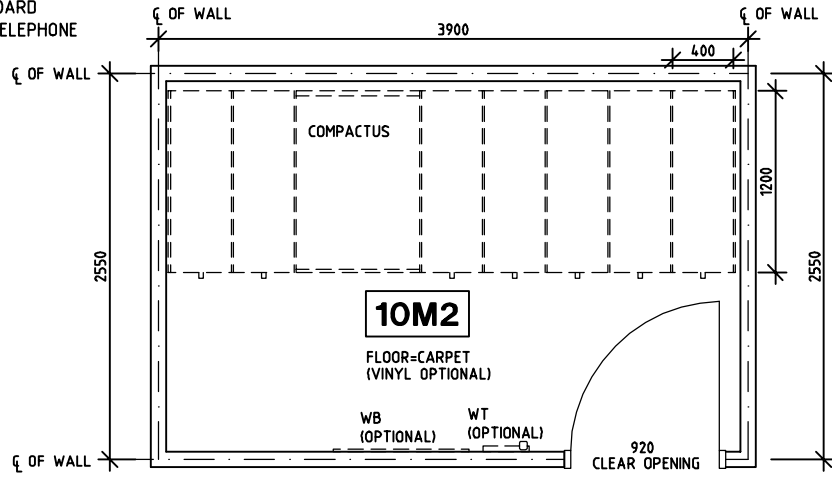

**OPTION 1- compactus shelving PLAN**

**OPTION 2- static shelving PLAN**

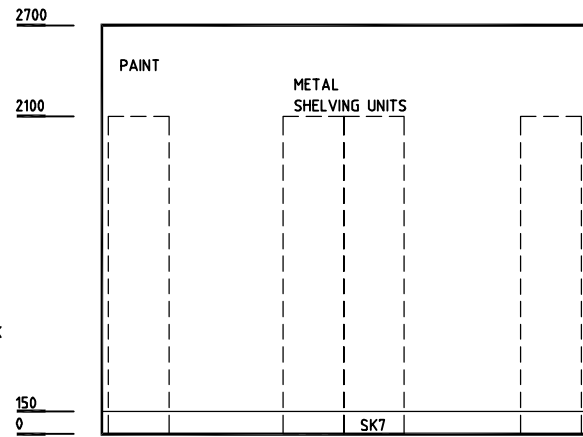
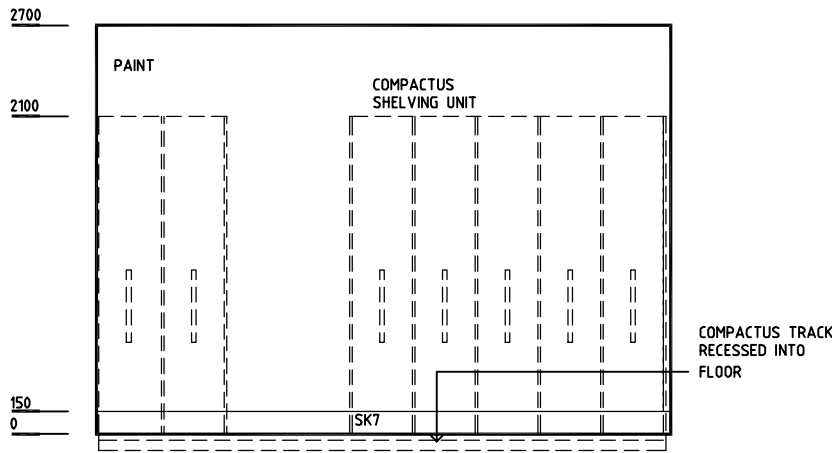

**ELEVATION 1**

**ELEVATION 1**

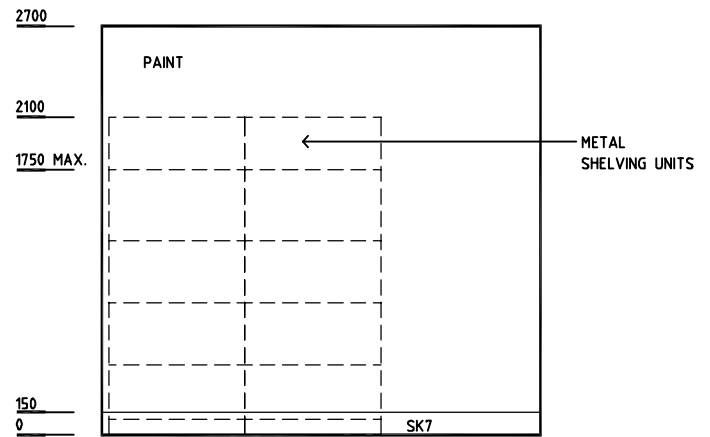
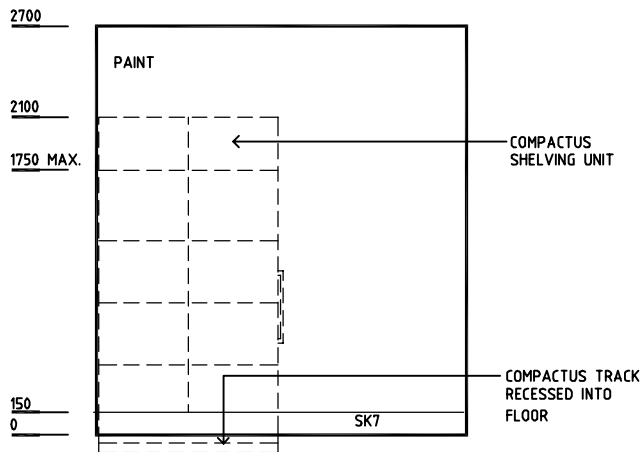

**ELEVATION 2**

**ELEVATION 2**

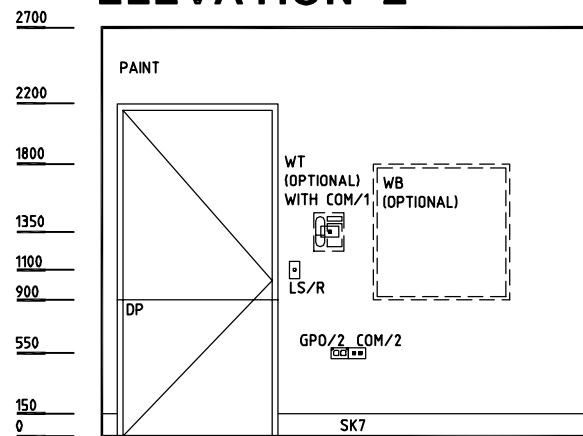
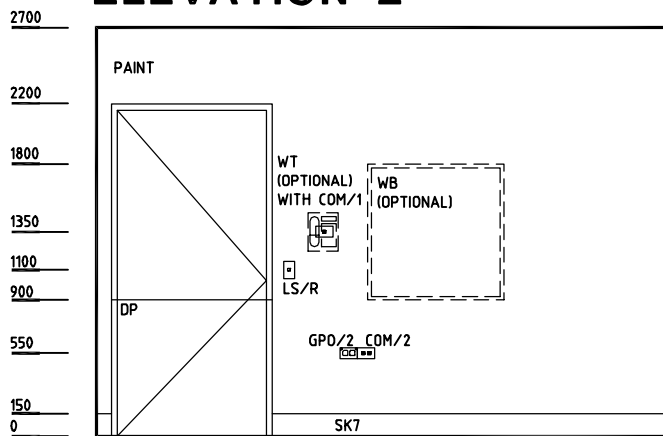

**ELEVATION 3**

**ELEVATION 3**

REV	DESCRIPTION	DATE	BY	REV	DESCRIPTION	DATE	BY	REV	DESCRIPTION	DATE	BY
1	FIRST ISSUE	14.03.2014	AA								



Sharjah Health Facility Guidelines at:  
www.healthdesign.com.au/shcc/hfg  
Editable version of Standard Components on  
Health Facility Briefing System (HFBS) at:  
www.healthdesign.com.au  
Provided by TAHPI

DESIGNED	APPROVED	DATE	SCALE(S)	SHEET
CC	DB	30.12.13	1:50 in A3	1 of 1
CAD FILE NAME		PAPER DRAWING ID		ISSUE
STFS-10-SJ		STFS-10-SJ		1

This document is for advisory purpose only