

SHARJAH HEALTHCARE CITY STANDARD COMPONENTS

Room Layout Sheet

Room Name | **Store - Disaster Equipment**

RLS Room Code | **STDE-SJ**
RDS Room Code | **STDE-SJ**

- AS | ADJUSTABLE SHELF
- DP | DOOR AND DOOR FRAME PROTECTION
- GPO/2 | GENERAL POWER OUTLET-DOUBLE
- LS/R | LIGHT SWITCH - ROOM
- SK4 | FLOOR VINYL COVED SKIRTING
- V1 | VINYL FLOORING, STANDARD SLIP RESISTANT

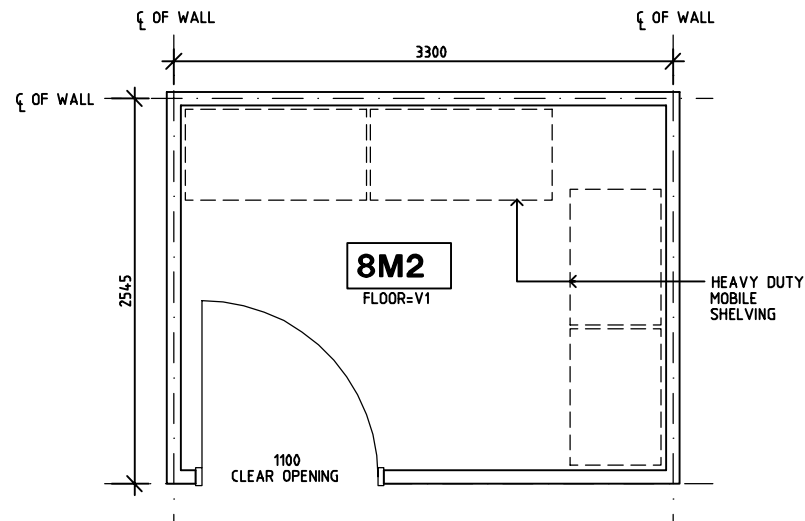

PLAN

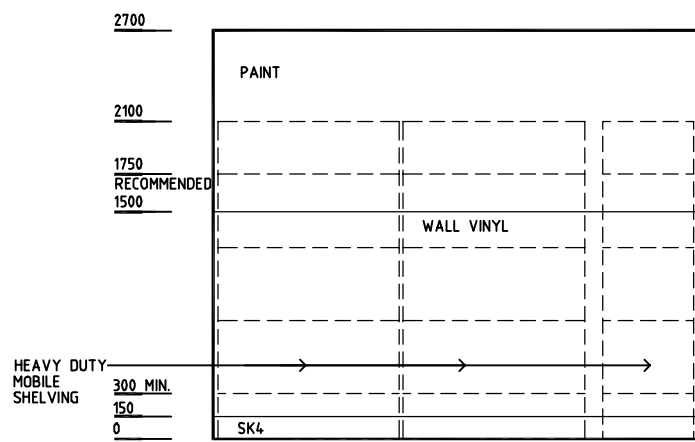

ELEVATION 1

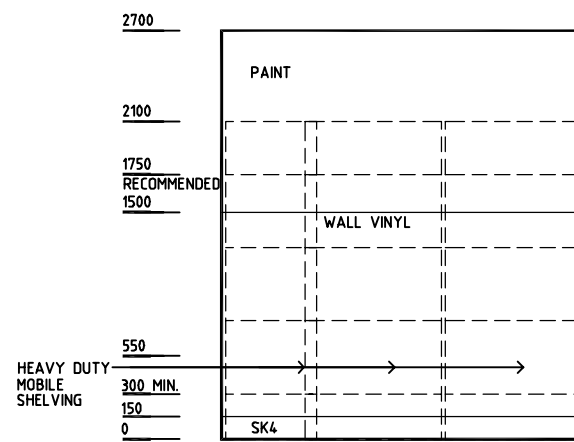

ELEVATION 2

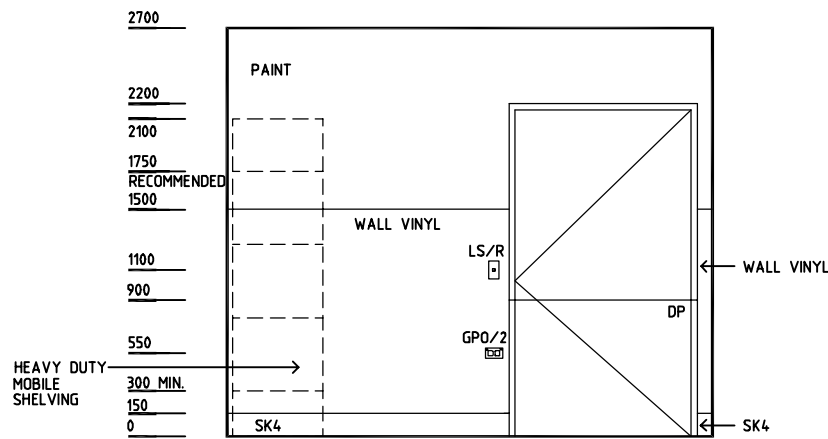

ELEVATION 3

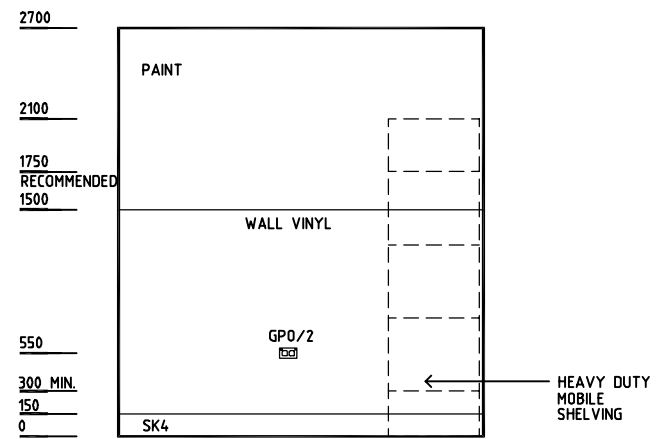

ELEVATION 4

REV	DESCRIPTION	DATE	BY	REV	DESCRIPTION	DATE	BY	REV	DESCRIPTION	DATE	BY
1	FIRST ISSUE	14.03.2014	AA								



Sharjah Health Facility Guidelines at:
www.healthdesign.com.au/shcc/hfg
Editable version of Standard Components on
Health Facility Briefing System (HFBS) at:
www.healthdesign.com.au
Provided by TAHPI

DESIGNED	APPROVED	DATE	SCALE(S)	SHEET
CC	DB	30.12.13	1:50 in A3	1 of 1
CAD FILE NAME		PAPER DRAWING ID		ISSUE
STDE-SJ		STDE-SJ		1