

SHARJAH HEALTHCARE CITY STANDARD COMPONENTS

Room Layout Sheet

Room Name **Servery/ Trolley Holding (Mental Health)**

RLS Room Code **SERV-MH-SJ**
RDS Room Code **SERV-MH-SJ**

- AS ADJUSTABLE SHELF
- BWU BOILING WATER UNIT
- CR CRASHRAIL
- DHT DISPENSER - HAND TOWEL
- DS DISPENSER - SOAP
- FS FIXED SHELF
- GPO/1 GENERAL POWER OUTLET - SINGLE
- GPO/2 GENERAL POWER OUTLET - DOUBLE
- GPO/S GENERAL POWER OUTLET - SPECIAL
- LS/R LIGHT SWITCH-SWITCH
- PB PINBOARD
- SS STAINLESS STEEL
- SK4 FLOOR VINYL COVERED SKIRTING
- V1 VINYL FLOORING STANDARD SLIP RESISTANT
- WT WALL TELEPHONE

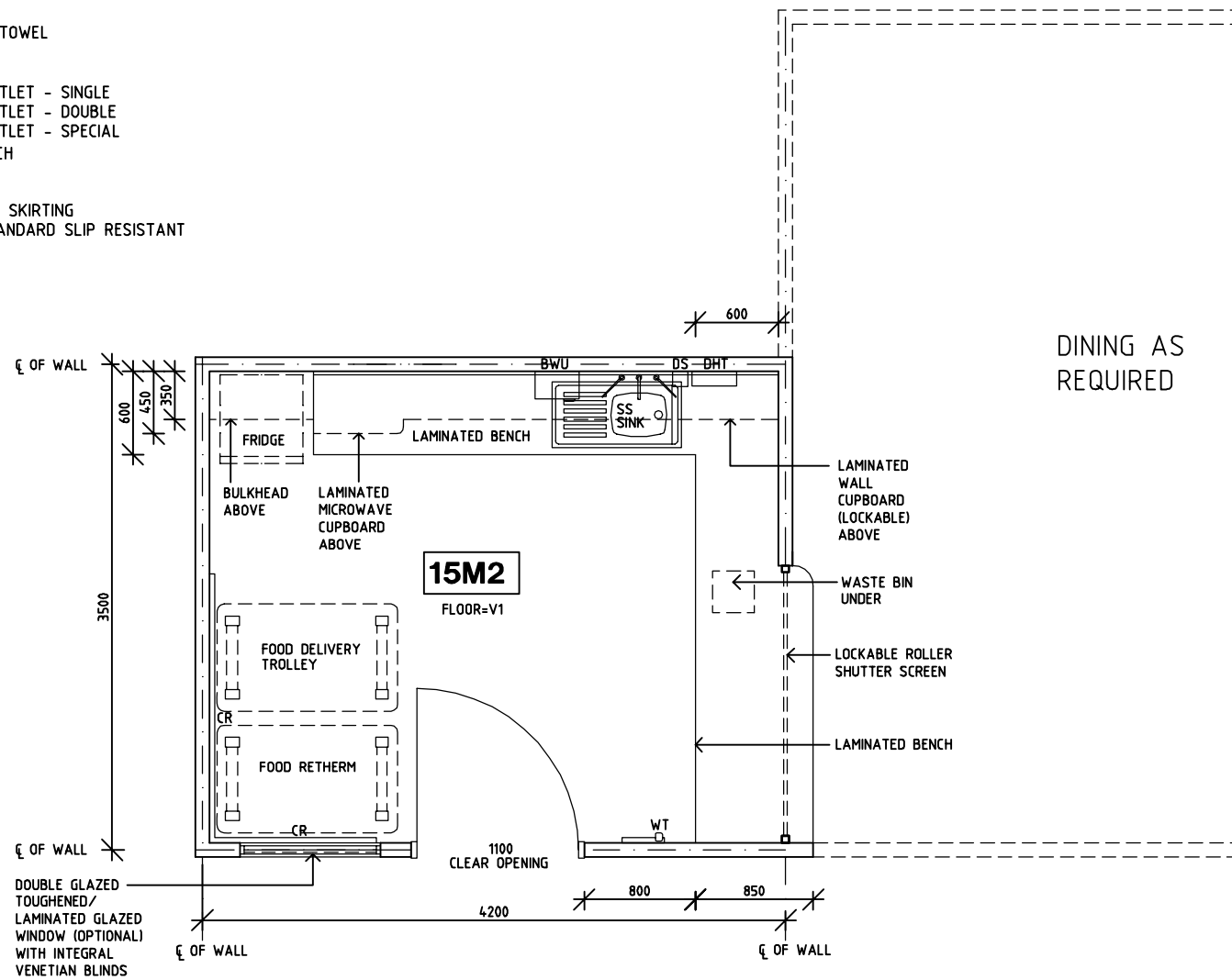

PLAN

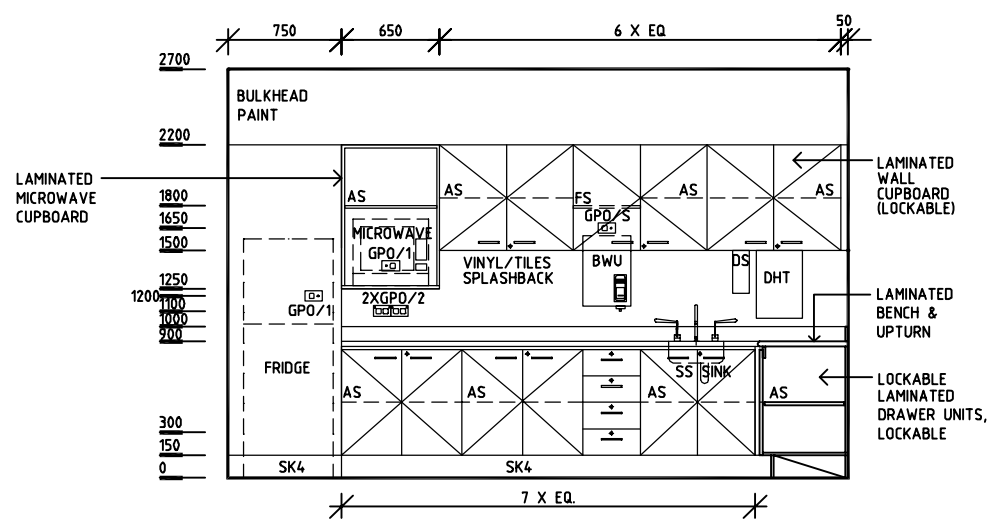

ELEVATION 1

REV	DESCRIPTION	DATE	BY	REV	DESCRIPTION	DATE	BY	REV	DESCRIPTION	DATE	BY
1	FIRST ISSUE	14.03.2014	AA								

	DESIGNED	APPROVED	DATE	SCALE(S)	SHEET
	CC	DB	30.12.13	1:50 in A3	1 of 2
	CAD FILE NAME		PAPER DRAWING ID		ISSUE
SERV-MH-SJ		SERV-MH-SJa		1	

This document is for advisory purpose only

Sharjah Health Facility Guidelines at:
www.healthdesign.com.au/shcc/hfg
Editable version of Standard Components on
Health Facility Briefing System (HFBS) at:
www.healthdesign.com.au
Provided by TAHPI

SHARJAH HEALTHCARE CITY STANDARD COMPONENTS

Room Layout Sheet

Room Name **Servery/ Trolley Holding (Mental Health)**

RLS Room Code **SERV-MH-SJ**
RDS Room Code **SERV-MH-SJ**

AS	ADJUSTABLE SHELF
BWU	BOILING WATER UNIT
CR	CRASHRAIL
DHT	DISPENSER - HAND TOWEL
DS	DISPENSER - SOAP
FS	FIXED SHELF
GPO/1	GENERAL POWER OUTLET - SINGLE
GPO/2	GENERAL POWER OUTLET - DOUBLE
GPO/S	GENERAL POWER OUTLET - SPECIAL
LS/R	LIGHT SWITCH-SWITCH
PB	PINBOARD
SS	STAINLESS STEEL
SK4	FLOOR VINYL COVERED SKIRTING
V1	VINYL FLOORING STANDARD SLIP RESISTANT
WT	WALL TELEPHONE

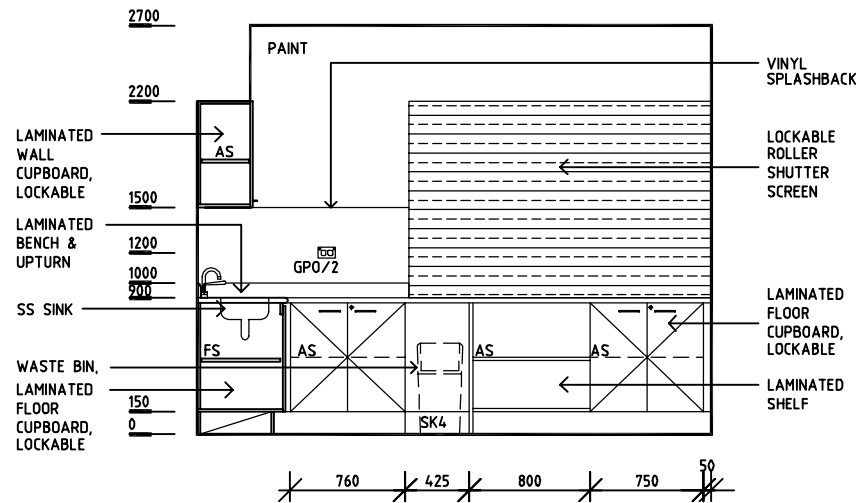

ELEVATION 2

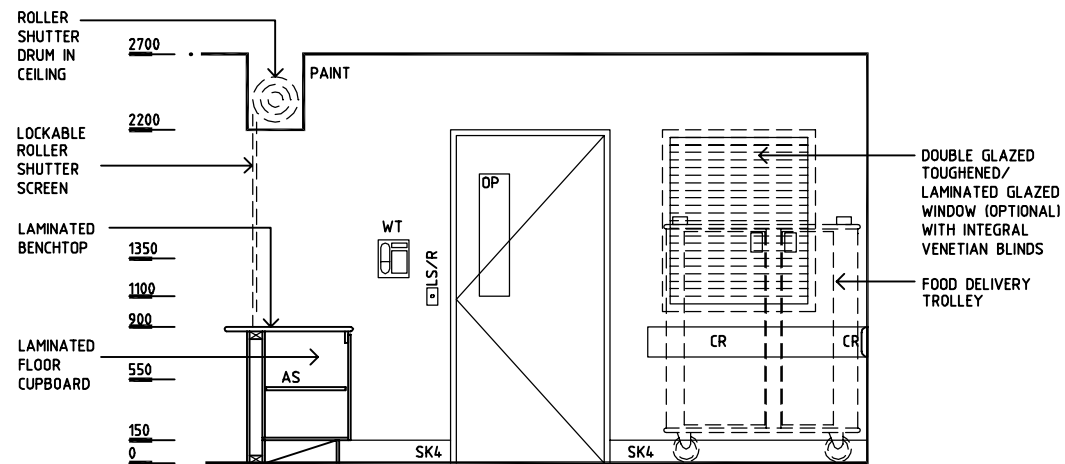

ELEVATION 3

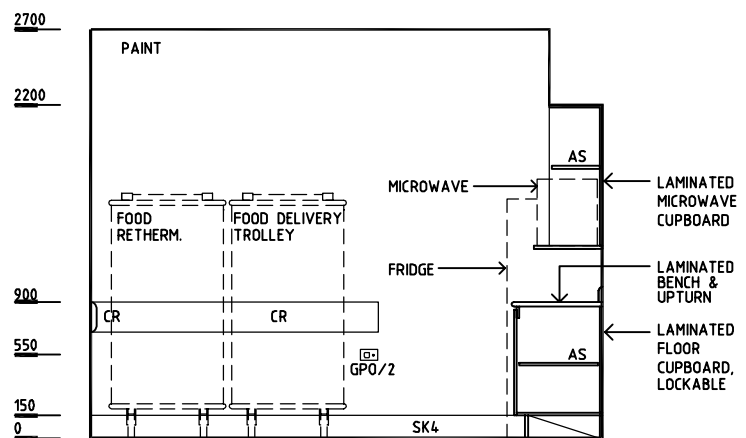

ELEVATION 4

REV	DESCRIPTION	DATE	BY	REV	DESCRIPTION	DATE	BY	REV	DESCRIPTION	DATE	BY
1	FIRST ISSUE	14.03.2014	AA								

	DESIGNED	APPROVED	DATE	SCALE(S)	SHEET
	CC	DB	30.12.13	1:50 in A3	2 of 2
	CAD FILE NAME		PAPER DRAWING ID		ISSUE
SERV-MH-SJ		SERV-MH-SJb		1	

This document is for advisory purpose only