

SHARJAH HEALTHCARE CITY STANDARD COMPONENTS

Room Layout Sheet

Room Name **Mould Room - Workshop**

RLS Room Code **MLD-WS-SJ**

RDS Room Code **MLD-WS-SJ**

- AS ADJUSTABLE SHELF
- COH COAT HOOK
- COM/1 COMMUNICATIONS OUTLET-SINGLE
- COM/2 COMMUNICATIONS OUTLET-DOUBLE
- DHT DISPENSER - HAND TOWEL
- DS DISPENSER - SOAP
- DP DOOR AND DOOR FRAME PROTECTION
- GPO/2 GENERAL POWER OUTLET-DOUBLE
- LS/R LIGHT SWITCH-ROOM
- LS/P LIGHT SWITCH-PELMET TASK LIGHT
- SK4 FLOOR VINYL COVED SKIRTING
- V1 VINYL FLOORING, STANDARD SLIP RESISTANT
- WT WALL TELEPHONE

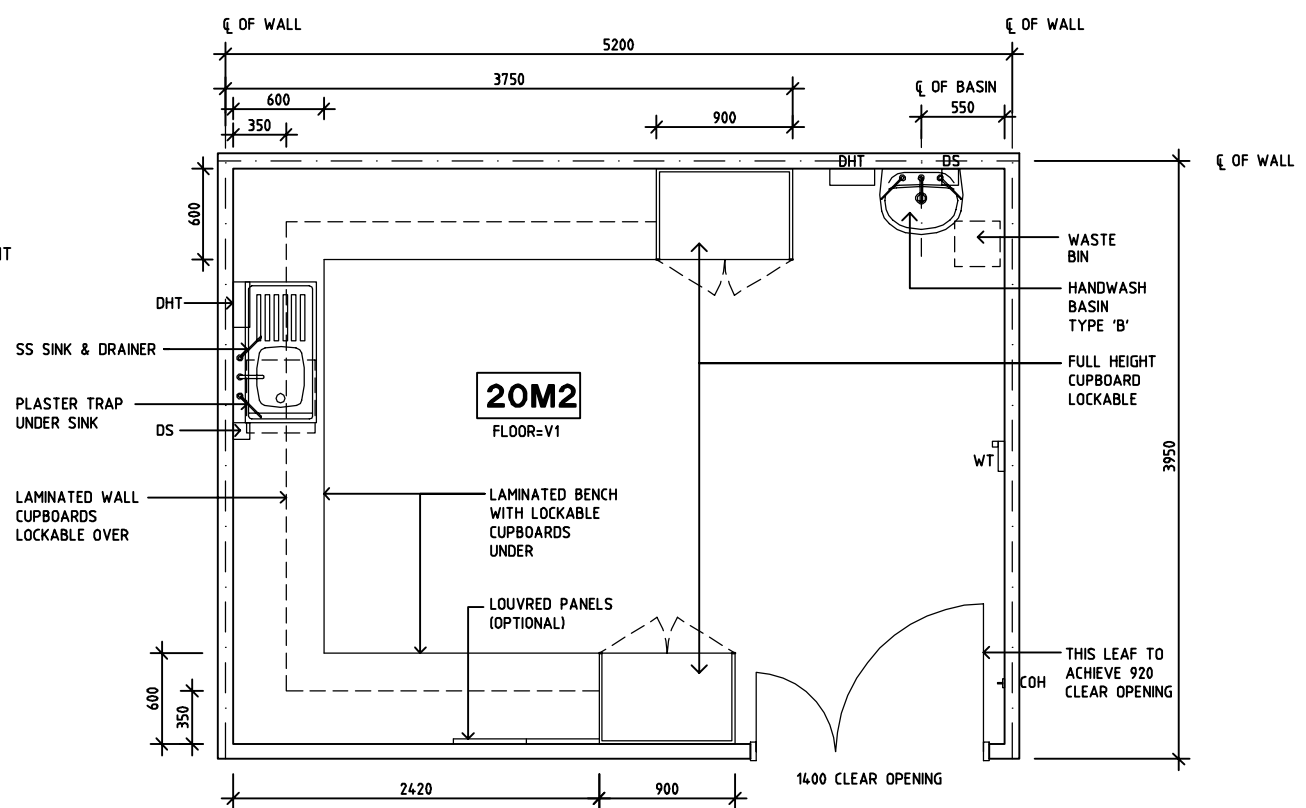

PLAN

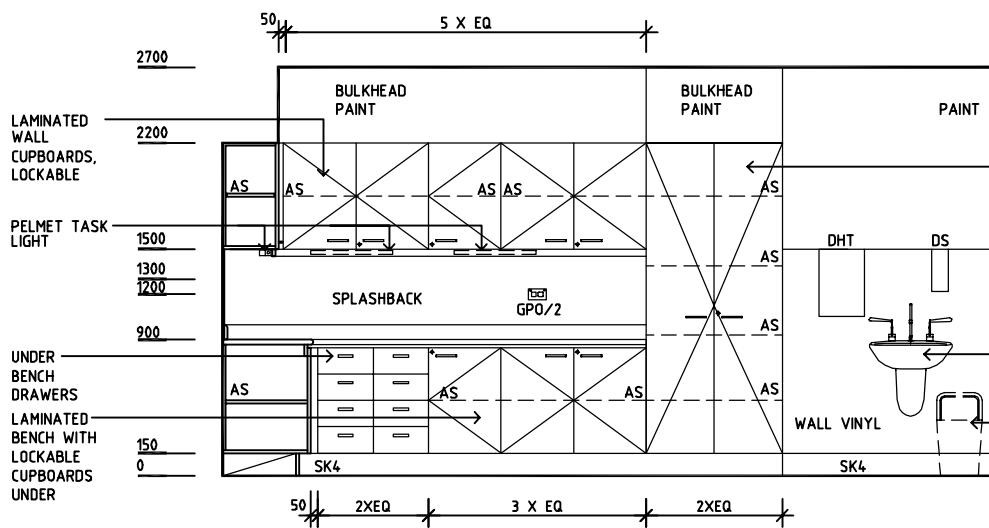

ELEVATION 1

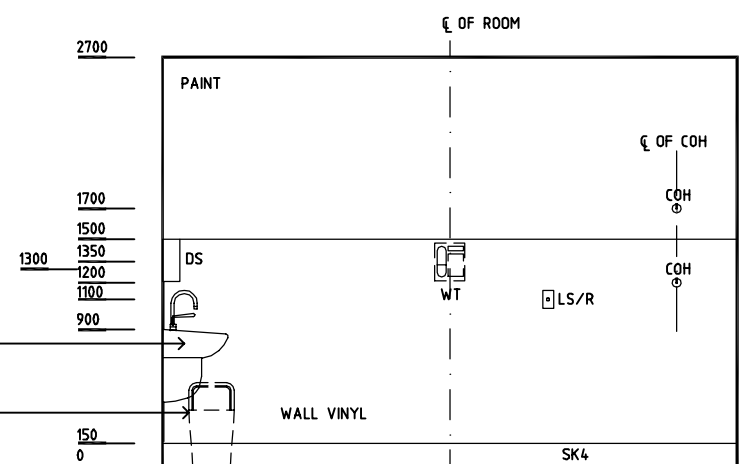

ELEVATION 2

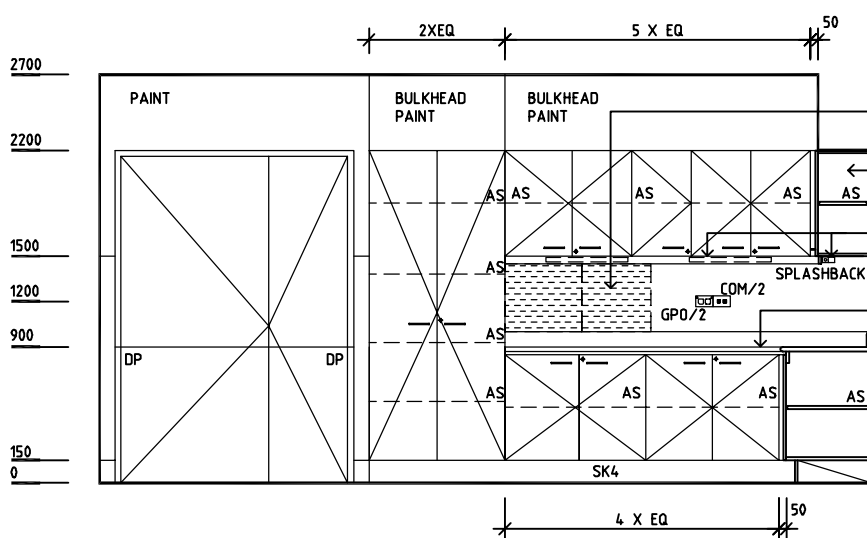

ELEVATION 3

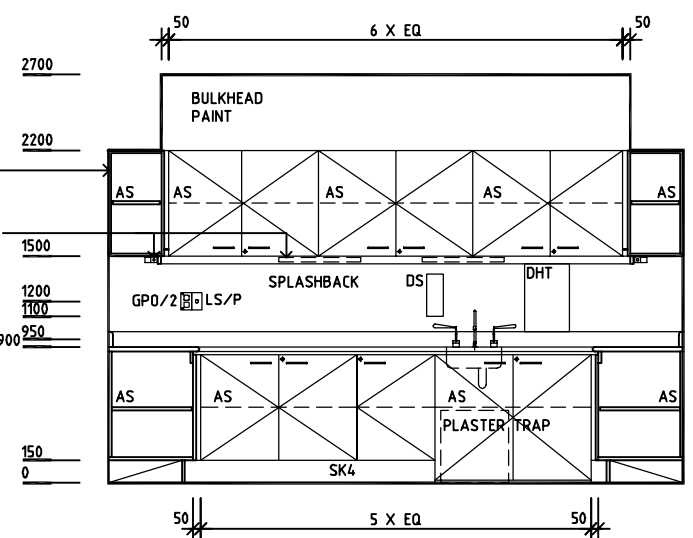

ELEVATION 4

REV	DESCRIPTION	DATE	BY	REV	DESCRIPTION	DATE	BY	REV	DESCRIPTION	DATE	BY
1	FIRST ISSUE	14.03.2014	AA								

	DESIGNED	APPROVED	DATE	SCALE(S)	SHEET
	CC	AA/DB	30.12.13	1:50 in A3	1 of 1
	CAD FILE NAME	PAPER DRAWING ID	ISSUE		
MLD-WS-SJ		MLD-WS-SJ	1		

Sharjah Health Facility Guidelines at:
www.healthdesign.com.au/shcc/hfg
 Editable version of Standard Components on
 Health Facility Briefing System (HFBS) at:
www.healthdesign.com.au
 Provided by TAHPI