

# SHARJAH HEALTHCARE CITY STANDARD COMPONENTS

Room Layout Sheet

Room Name **Meeting Room - Living Skills, 20m2**

RLS Room Code **MEET-LS-20-SJ**  
RDS Room Code **MEET-LS-20-SJ**

- AS ADJUSTABLE SHELF
- COM/2 COMMUNICATION OUTLET, DOUBLE
- DHT DISPENSER-HAND TOWEL
- DS DISPENSER-SOAP
- FS FIXED SHELF
- GPO/2 GENERAL POWER OUTLET-DOUBLE
- GPO/C GENERAL POWER OUTLET-CLEANER
- LS/R LIGHT SWITCH-ROOM
- LS/D LIGHT SWITCH-DIMMER
- MATV MASTER ANTENNA TV
- OP OBSERVATION PANEL
- PB PINBOARD
- RCD RESIDUAL CURRENT DEVICE
- SK4 FLOOR VINYL COVERED SKIRTING
- V1 FLOOR VINYL STANDARD SLIP RESISTANT
- WB WHITEBOARD
- WT WALL TELEPHONE

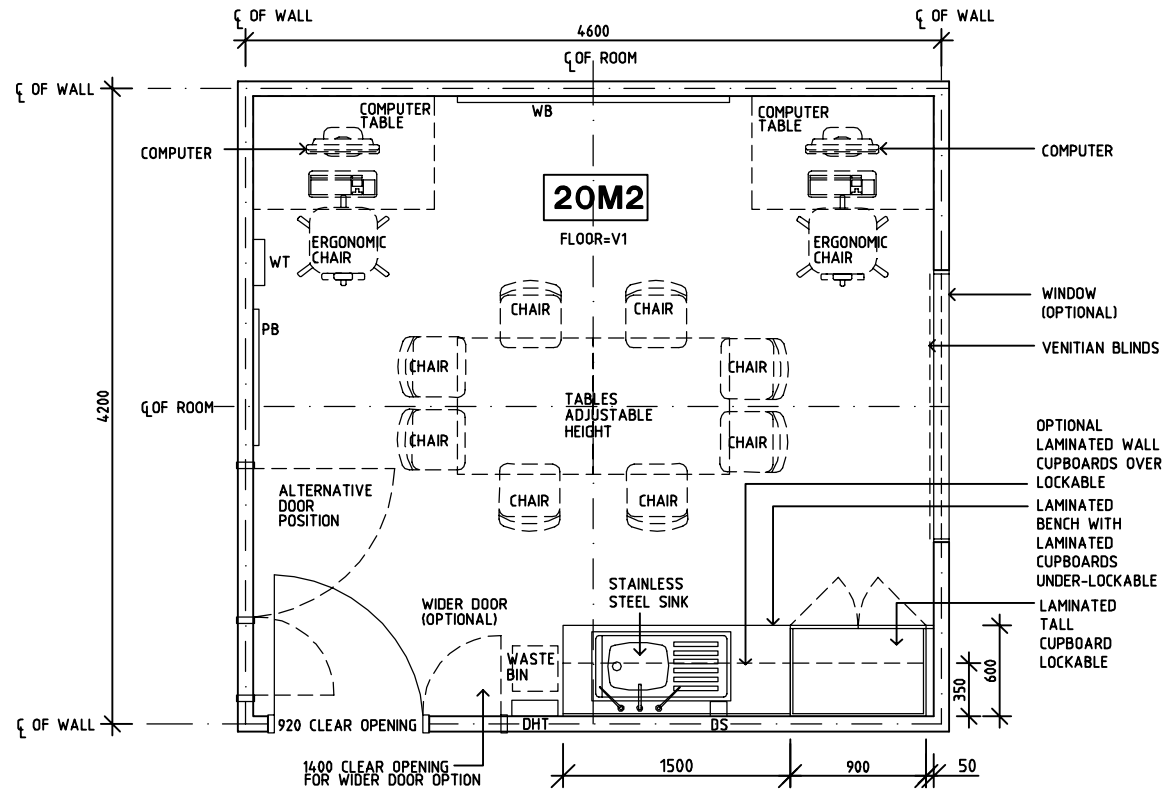

**PLAN**

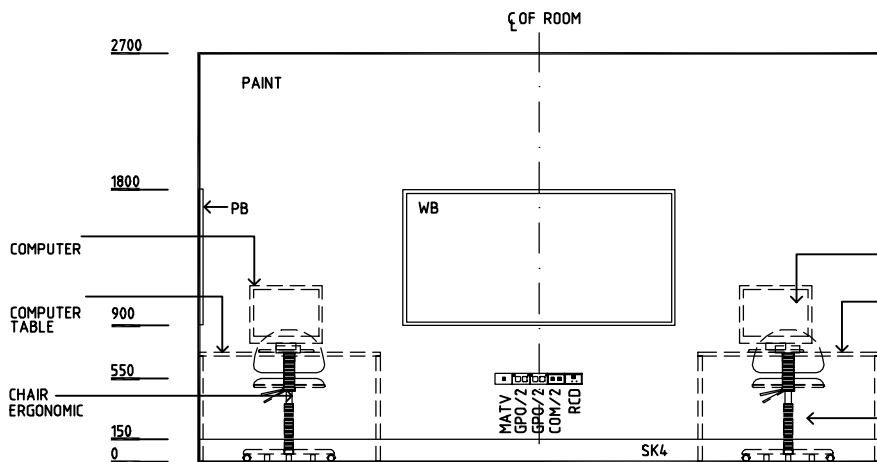

**ELEVATION 1**

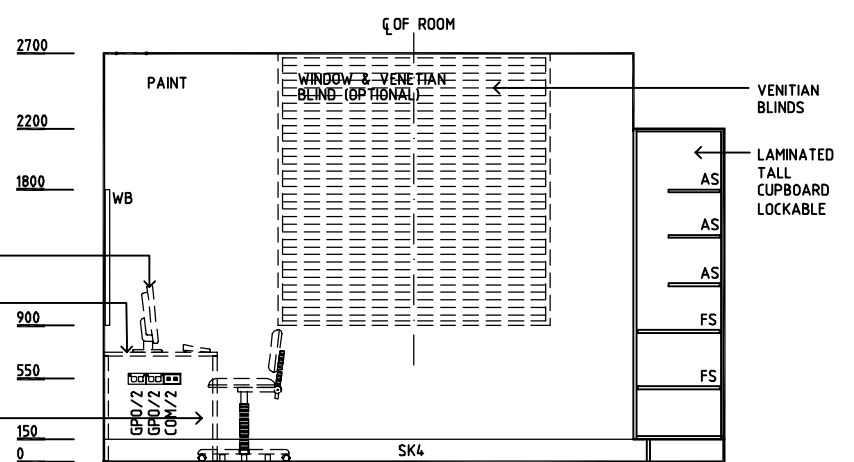

**ELEVATION 2**

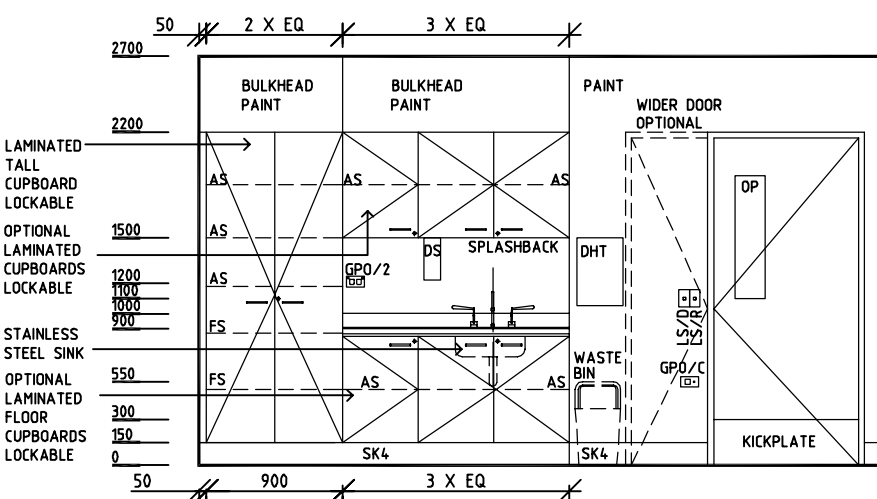

**ELEVATION 3**

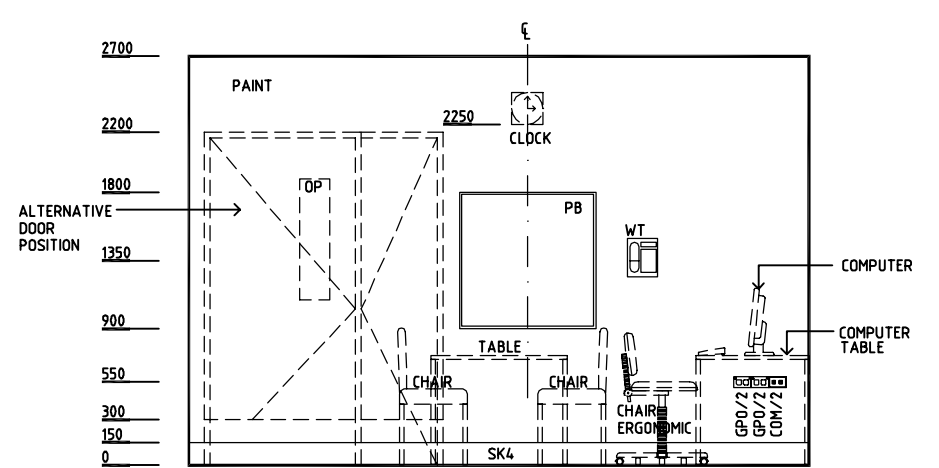

**ELEVATION 4**

REV	DESCRIPTION	DATE	BY	REV	DESCRIPTION	DATE	BY	REV	DESCRIPTION	DATE	BY
1	FIRST ISSUE	14.03.2014	AA								



Sharjah Health Facility Guidelines at:  
www.healthdesign.com.au/shccfig  
Editable version of Standard Components on  
Health Facility Briefing System (HFBS) at:  
www.healthdesign.com.au  
Provided by TAHPI

DESIGNED	APPROVED	DATE	SCALE(S)	SHEET
CC	DB	24.10.10	1:50 in A3	1 of 1
CAD FILE NAME		PAPER DRAWING ID		ISSUE
MEET-LS-20-SJ		MEET-LS-20-SJ		1

This document is for advisory purpose only