

# SHARJAH HEALTHCARE CITY STANDARD COMPONENTS

Room Layout Sheet

Room Name **Computer Equipment Room**

RLS Room Code **COEQ-SJ**  
RDS Room Code **COEQ-SJ**

- GP0/S GENERAL POWER OUTLET - SPECIAL SINGLE
- LS/R LIGHT SWITCH - ROOM
- SK4 VINYL FLOOR COVERED SKIRTING
- UPS UNINTERRUPTED POWER SUPPLY
- V1 VINYL FLOORING, STANDARD SLIP RESISTANT

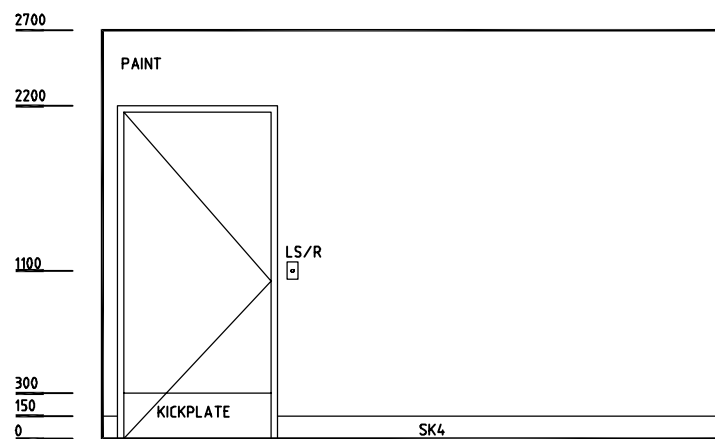
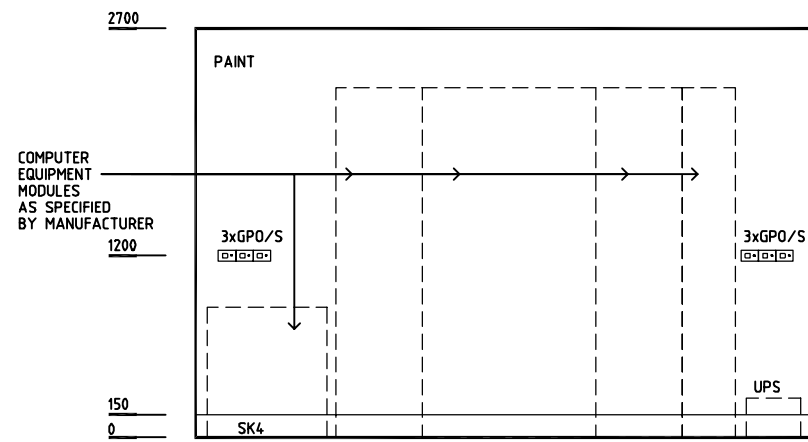
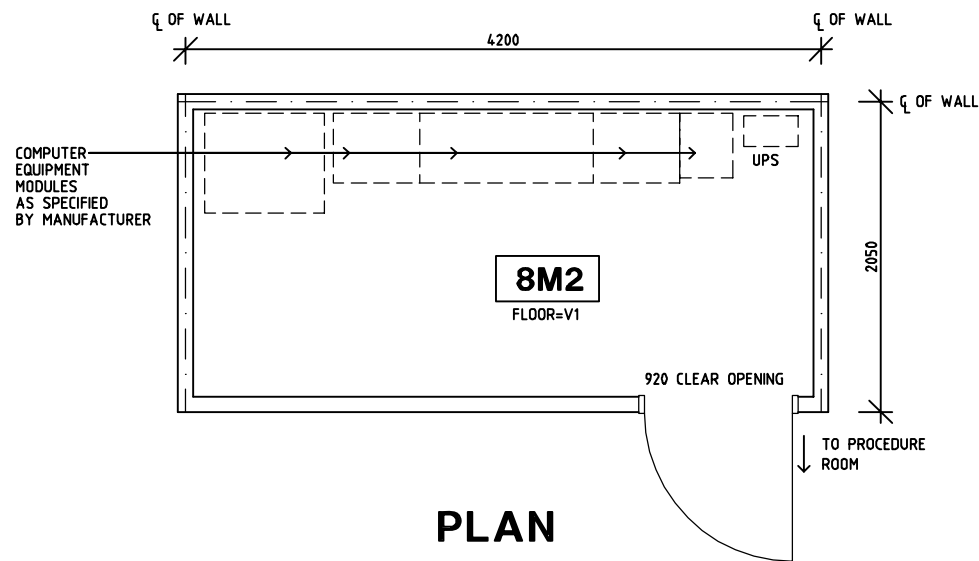

REV	DESCRIPTION	DATE	BY	REV	DESCRIPTION	DATE	BY	REV	DESCRIPTION	DATE	BY
1	FIRST ISSUE	14.03.2014	AA								

	Sharjah Health Facility Guidelines at: <a href="http://www.healthdesign.com.au/shcc/hfg">www.healthdesign.com.au/shcc/hfg</a> Editable version of Standard Components on Health Facility Briefing System (HFBS) at: <a href="http://www.healthdesign.com.au">www.healthdesign.com.au</a> Provided by TAHPI				DESIGNED	APPROVED	DATE	SCALE(S)	SHEET
	CC	DB	30.12.13	1:50 in A3	1 of 1				
	CAD FILE NAME		PAPER DRAWING ID		ISSUE				
COEQ-SJ		COEQ-SJ		1					

This document is for advisory purpose only