

SHARJAH HEALTHCARE CITY STANDARD COMPONENTS

Room Layout Sheet

Room Name

Anaesthetic Store

RLS Room Code ANST-SJ  
RDS Room Code ANST-SJ

- AS

COM/2

CR

DP

FS

GPO/1

GPO/2

LS/R

LS/P

OP

SK4

V1

WB
- ADJUSTABLE SHELF

COMMUNICATION OUTLET-DOUBLE

CRASH RAIL

DOOR & DOOR FRAME PROTECTION

FIXED SHELF

GENERAL POWER OUTLET - SINGLE

GENERAL POWER OUTLET - DOUBLE

LIGHT SWITCH - ROOM

LIGHT SWITCH- PELMET LIGHTS

OBSERVATION PANEL

FLOOR VINYL COVED SKIRTING

VINYL FLOORING, STANDARD

WHITEBOARD

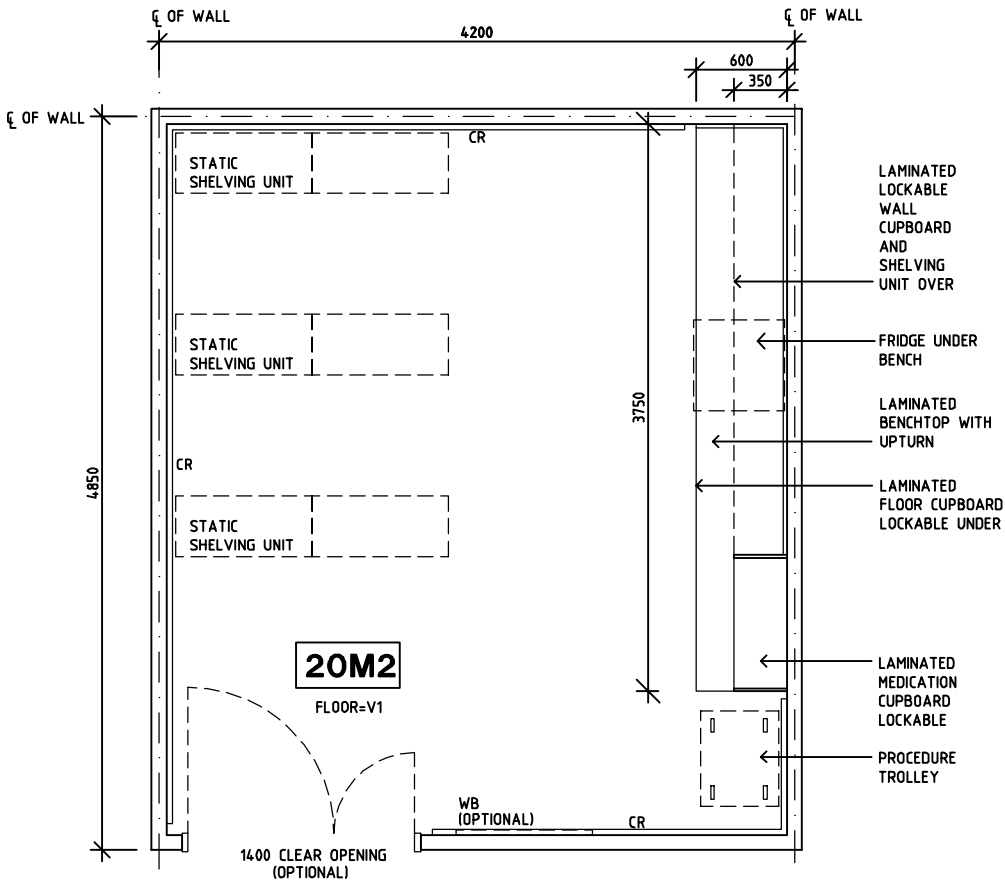

PLAN

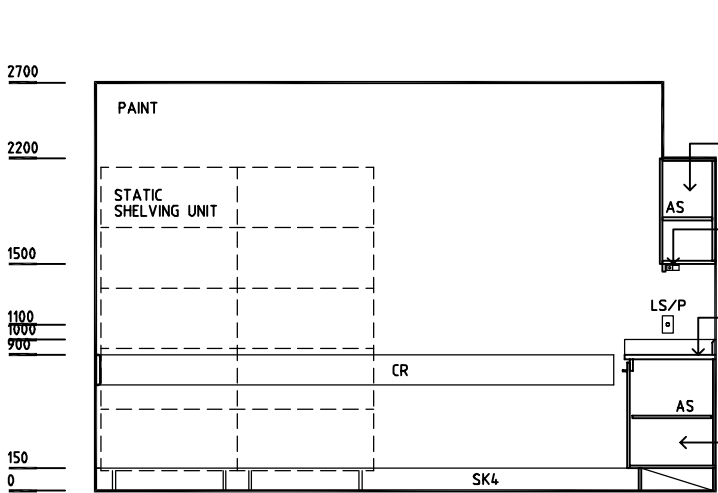

ELEVATION 1

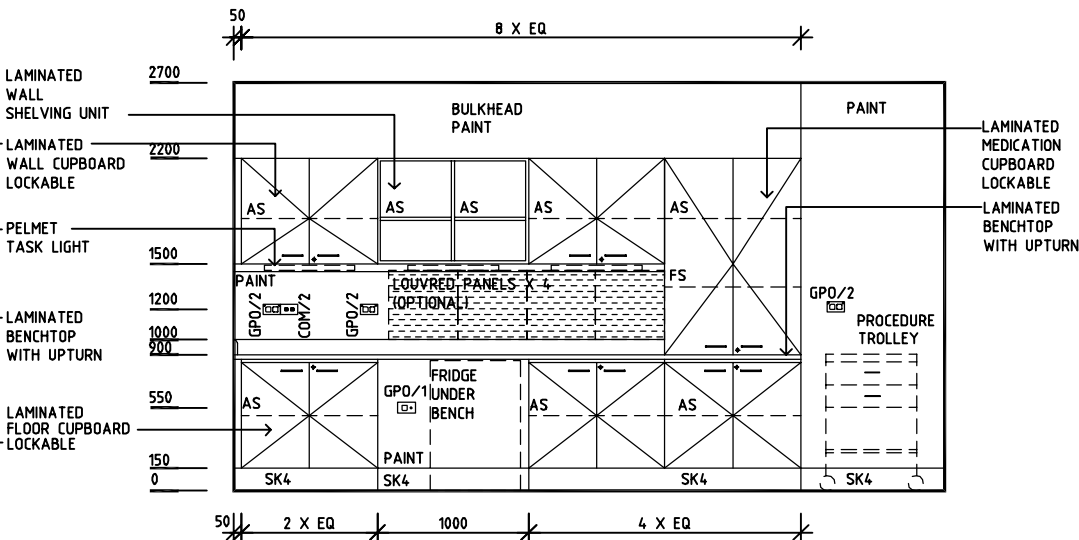

ELEVATION 2

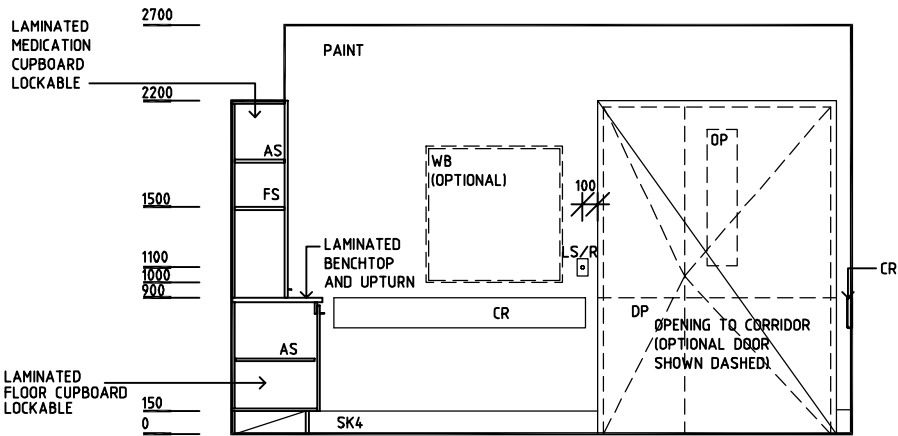

ELEVATION 3

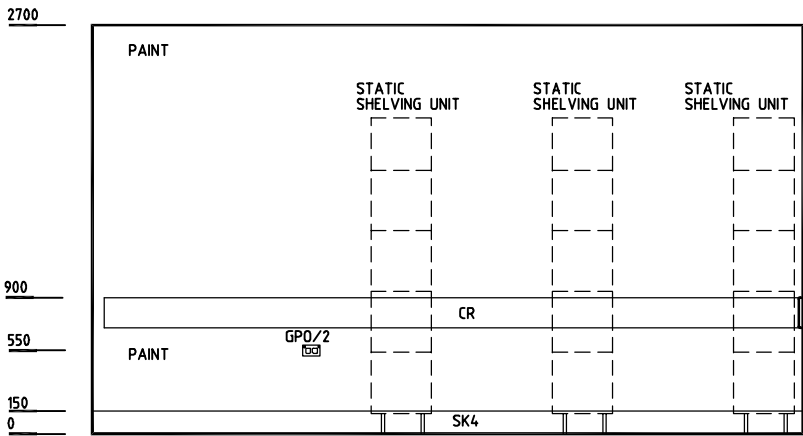

ELEVATION 4

REV	DESCRIPTION	DATE	BY	REV	DESCRIPTION	DATE	BY	REV	DESCRIPTION	DATE	BY
1	FIRST ISSUE	14.03.2014	AA								

	<h1>SHCC Guidelines</h1>	<p>Sharjah Health Facility Guidelines at: <a href="http://www.healthdesign.com.au/shccfig">www.healthdesign.com.au/shccfig</a> Editable version of Standard Components on Health Facility Briefing System (HFBS) at: <a href="http://www.healthdesign.com.au">www.healthdesign.com.au</a> Provided by TAHPI</p>	DESIGNED	APPROVED	DATE	SCALE(S)	SHEET
			CC	DB	30.12.13	1:50 in A3	1 of 1
			CAD FILE NAME ANST-SJ		PAPER DRAWING ID ANST-SJ		ISSUE 1