

SHARJAH HEALTHCARE CITY STANDARD COMPONENTS

Room Layout Sheet

Room Name

After Hours Drug Store

RLS Room Code

AHDR-SJ

RDS Room Code

AHDR-SJ

- AS

COM/1

DP

GP0/2 EP

LS/R

LS/P

SK4

VI
- ADJUSTABLE SHELVING

COMMUNICATIONS OUTLET - SINGLE

DOOR AND DOOR FRAME PROTECTION

EMERGENCY POWER OUTLET, DOUBLE

LIGHT SWITCH - ROOM

LIGHT SWITCH - PELMET TASK LIGHT

FLOOR VINYL COVED SKIRTING

VINYL FLOORING, STANDARD

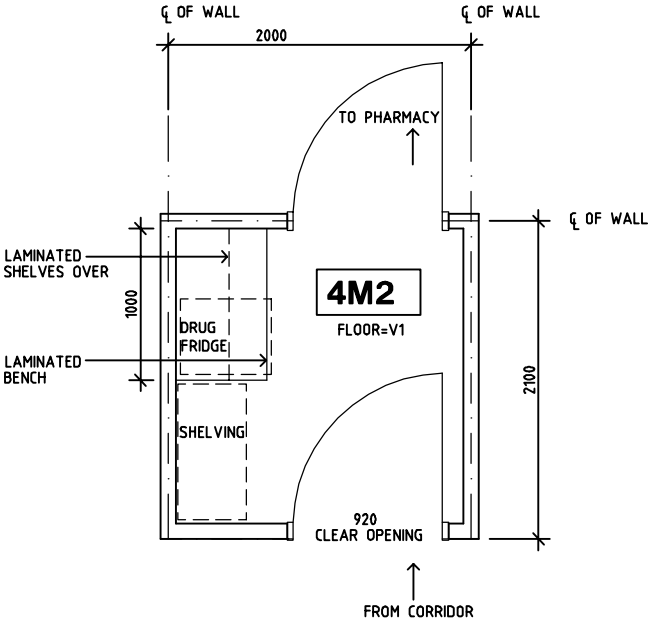

PLAN

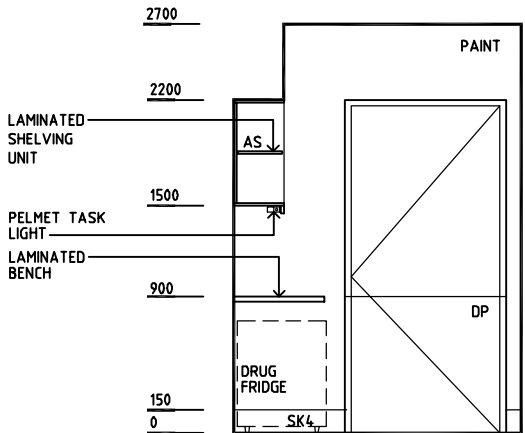

ELEVATION 1

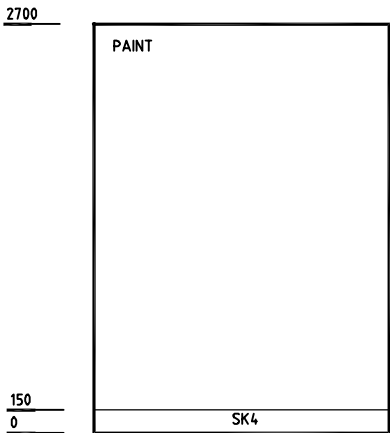

ELEVATION 2

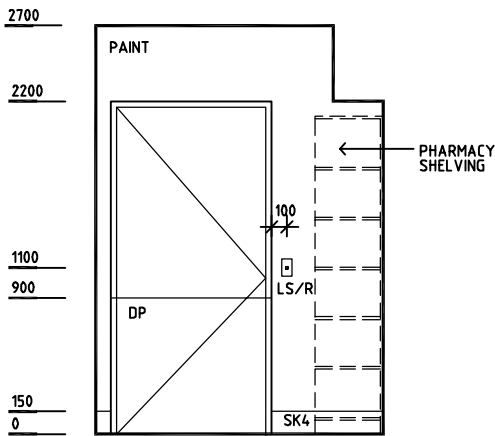

ELEVATION 3

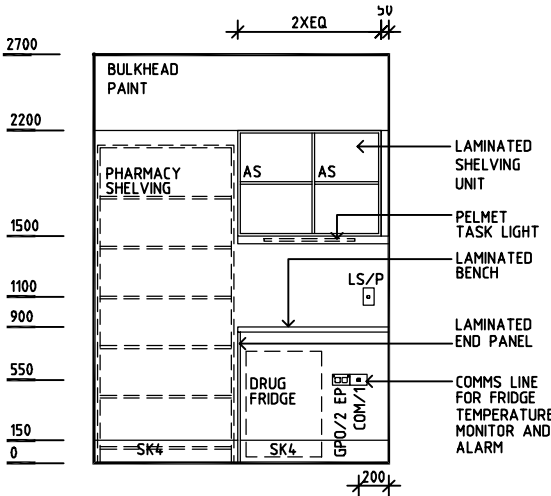

ELEVATION 4

REV	DESCRIPTION	DATE	BY	REV	DESCRIPTION	DATE	BY	REV	DESCRIPTION	DATE	BY
1	FIRST ISSUE	14.03.2014	AA								

	<div>Sharjah Health Facility Guidelines at: www.healthdesign.com.au/shcc-hfg Editable version of Standard Components on Health Facility Briefing System (HFBS) at: www.healthdesign.com.au Provided by TAHPI</div>					DESIGNED	APPROVED	DATE	SCALE(S)	SHEET
						CC	DB	30.12.13	1:50 in A3	1 of 1
						CAD FILE NAME AHDR-SJ	PAPER DRAWING ID AHDR-SJ		ISSUE 1	