

NSW HFG STANDARD COMPONENTS

Room Layout Sheet

Room Name **Store - Drugs, 10m2**

RLS Room Code **STDR-10**

RDS Room Code **STDR-10**

- AS ADJUSTABLE SHELF
- DHT DISPENSER - HAND TOWEL
- DP DOOR AND FRAME PROTECTION
- DS DISPENSER - SOAP
- FS FIXED SHELF
- GPO/1 GENERAL PURPOSE OUTLET-SINGLE
- LS/P LIGHT SWITCH - PELMET LIGHT
- LS/R LIGHT SWITCH - ROOM
- OP OBSERVATION PANEL
- SK4 FLOOR VINYL COVED SKIRTING
- V1 VINYL FLOORING, STANDARD

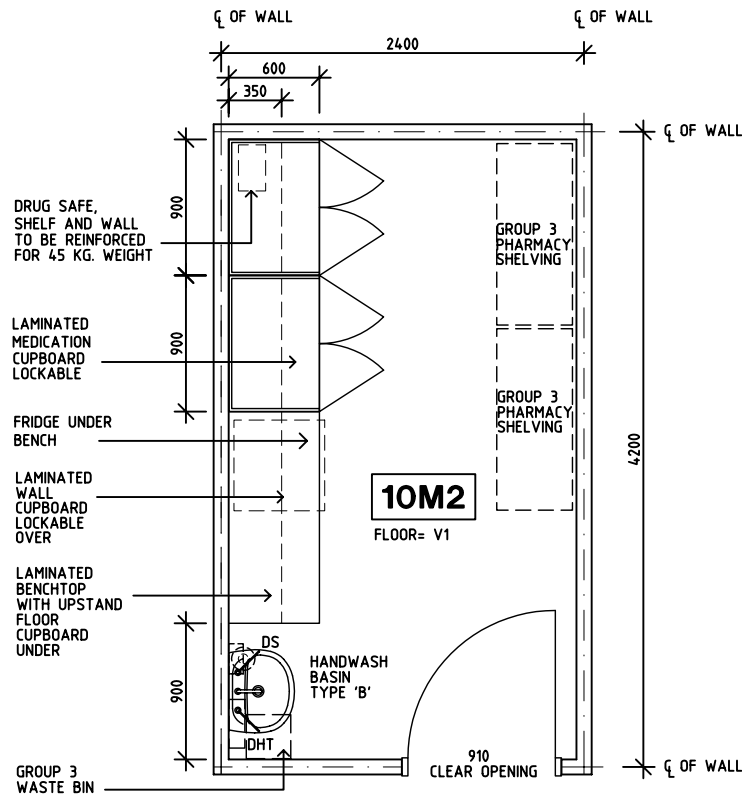

PLAN

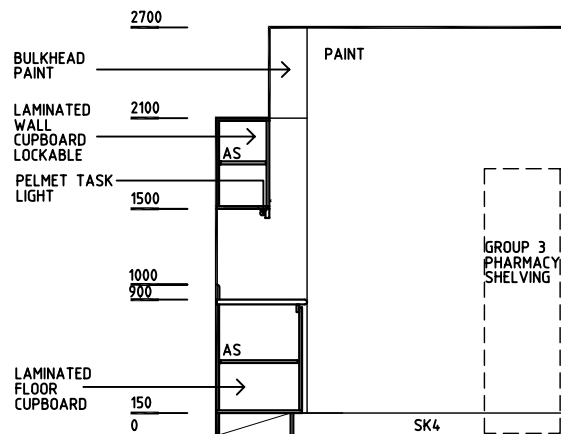

ELEVATION 1

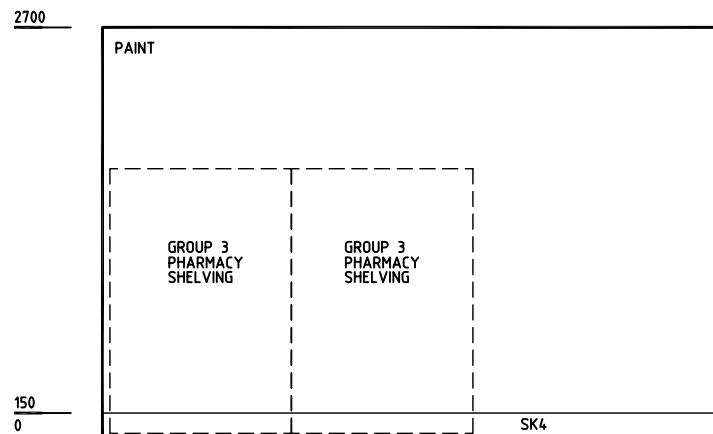

ELEVATION 2

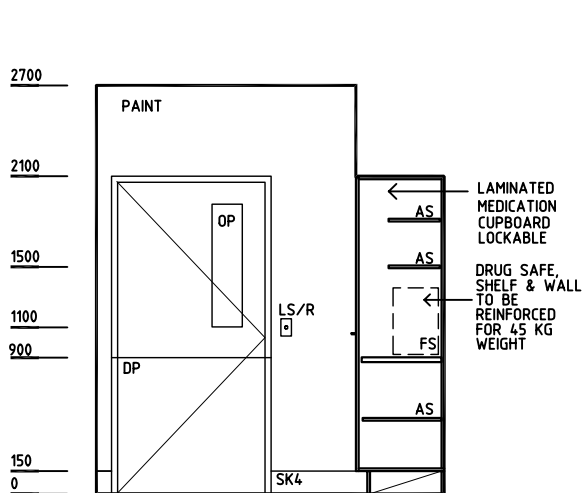

ELEVATION 3

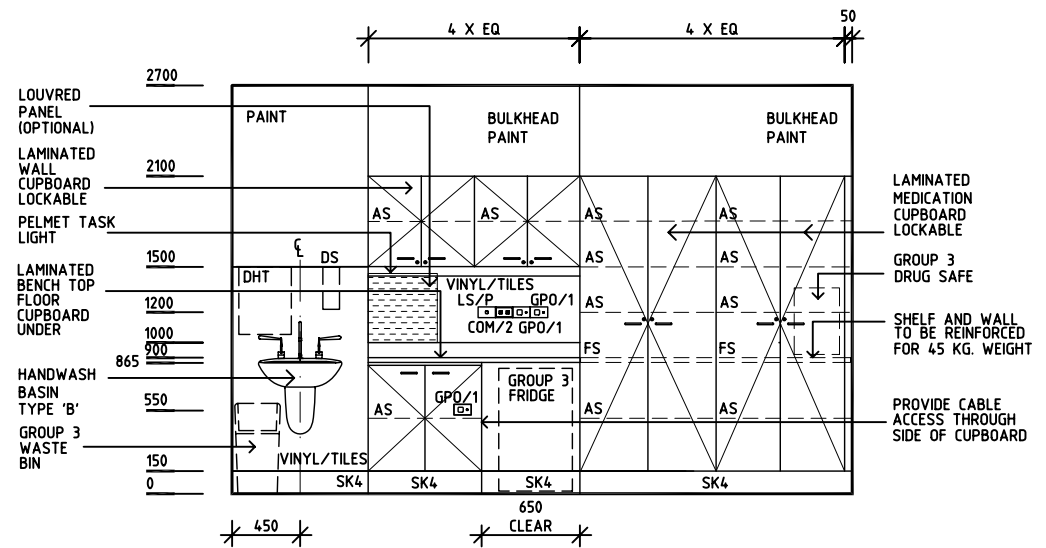

ELEVATION 4

REV	DESCRIPTION	DATE	BY	REV	DESCRIPTION	DATE	BY	REV	DESCRIPTION	DATE	BY
1	FIRST ISSUE	19.7.05	JMH								