

# NSW HFG STANDARD COMPONENTS

Room Layout Sheet

Room Name Pharmacy - Counter, 9m2

RLS Room Code PHA-CO

RDS Room Code PHA-CO

- CAC CABLE ACCESS CAP
- COM/2 COMMUNICATIONS/DATA OUTLET - DOUBLE
- DA DURESS ALARM
- GPO/2 GENERAL PURPOSE OUTLET - DOUBLE
- GPO/2 EP EMERGENCY POWER - DOUBLE
- LS LIGHT SWITCH
- OP OBSERVATION PANEL
- PB PINBOARD, FABRIC COVERED
- SK5 VINYL FEATHER EDGE SKIRTING

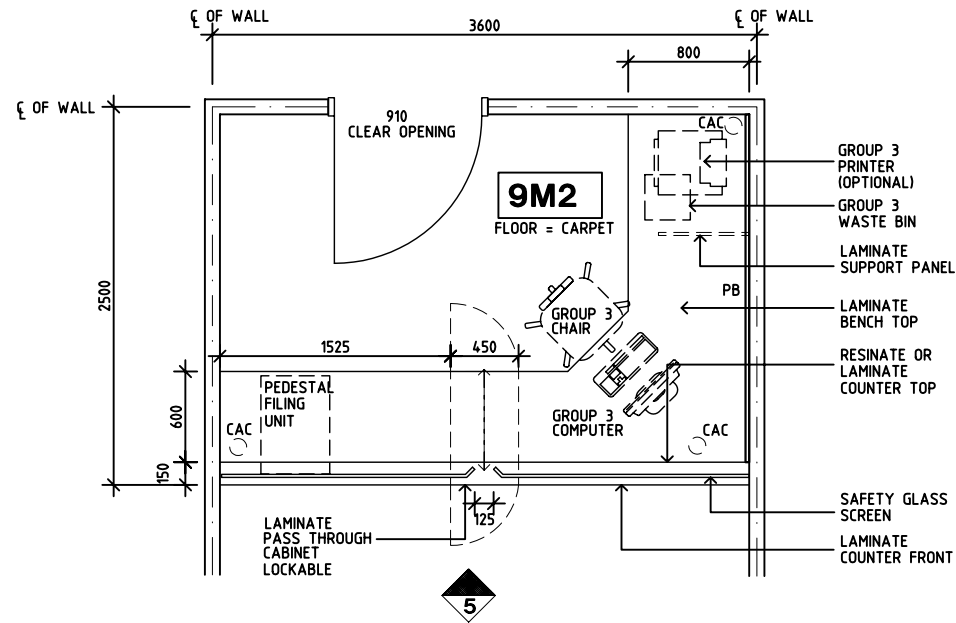

PLAN

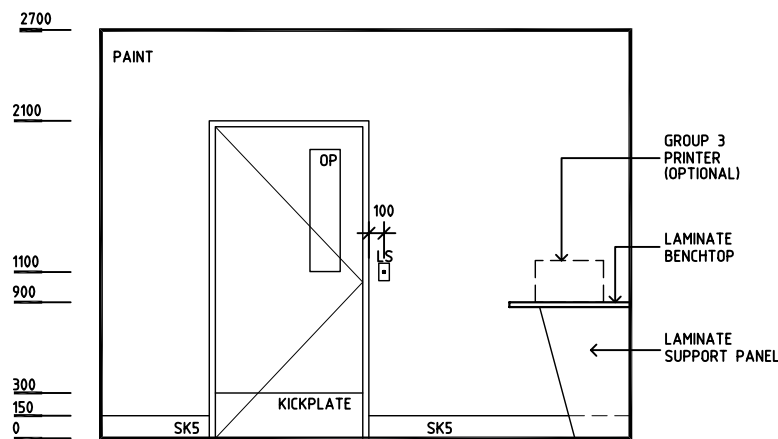

ELEVATION 1

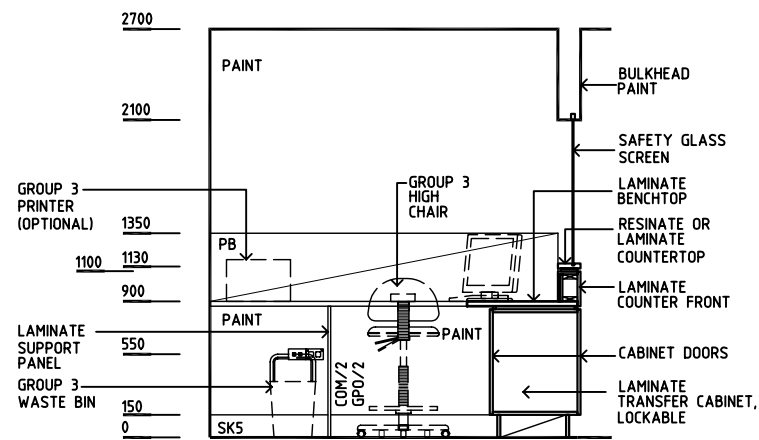

ELEVATION 2

REV	DESCRIPTION	DATE	BY	REV	DESCRIPTION	DATE	BY	REV	DESCRIPTION	DATE	BY
1	FIRST ISSUE	11.7.05	BJ								

# NSW HFG STANDARD COMPONENTS

Room Layout Sheet

Room Name Pharmacy - Counter, 9m<sup>2</sup>

RLS Room Code PHA-CO

RDS Room Code PHA-CO

- CAC CABLE ACCESS CAP
- COM/2 COMMUNICATIONS/DATA OUTLET - DOUBLE
- DA DURESS ALARM
- GPO/2 GENERAL PURPOSE OUTLET - DOUBLE
- GPO/2 EP EMERGENCY POWER - DOUBLE
- LS LIGHT SWITCH
- OP OBSERVATION PANEL
- PB PINBOARD, FABRIC COVERED
- SK5 VINYL FEATHER EDGE SKIRTING

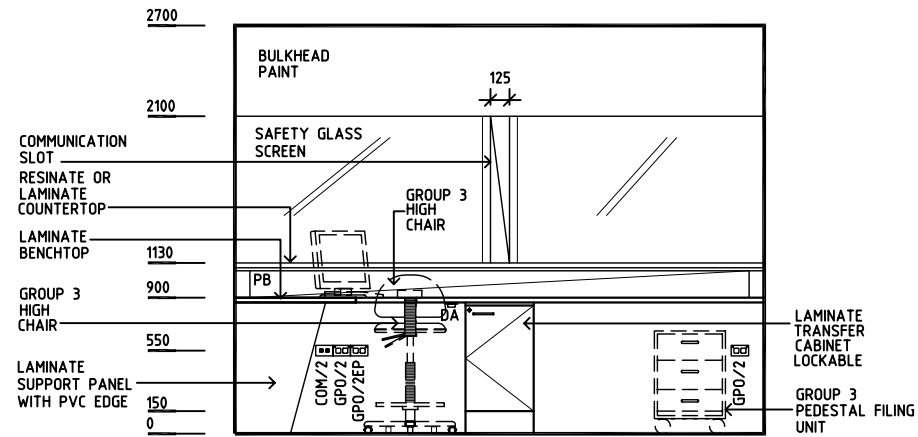

**ELEVATION 3**

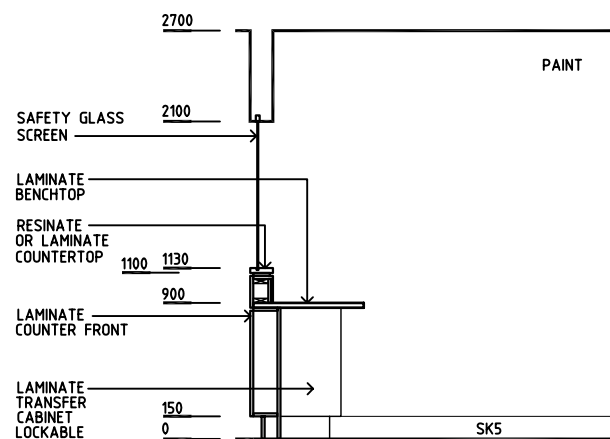

**ELEVATION 4**

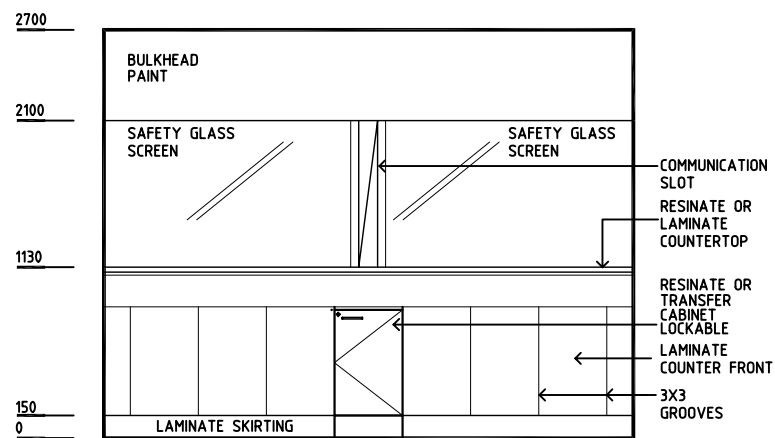

**ELEVATION 5**

REV	DESCRIPTION	DATE	BY	REV	DESCRIPTION	DATE	BY	REV	DESCRIPTION	DATE	BY
1	FIRST ISSUE	11.7.05	BJ								



THE UNIVERSITY OF  
NEW SOUTH WALES

HPI

DESIGNED AA/CC	APPROVED DB	SCALE(S) 1:50 in A3	ZONE(S)
CAD FILE NAME PHA-CO		PAPER DRAWING ID PHA-COb	