

# NSW HFG STANDARD COMPONENTS

Room Layout Sheet

Room Name **Office - Single Person, 12m2**

RLS Room Code **OFF-S12**

RDS Room Code **OFF-S12**

- CAC CABLE ACCESS CAP
- COH COAT HOOK
- COM/1 COMMUNICATION OUTLET - SINGLE
- COM/2 COMMUNICATION OUTLET - DOUBLE
- FC/4 FILING CABINET, 4 DRAWERS
- GPO/1 GENERAL PURPOSE OUTLET - SINGLE
- GPO/2 GENERAL PURPOSE OUTLET - DOUBLE
- LS LIGHT SWITCH
- PB PINBOARD
- SK5 FEATHER EDGE VINYL SKIRTING
- WB WHITEBOARD

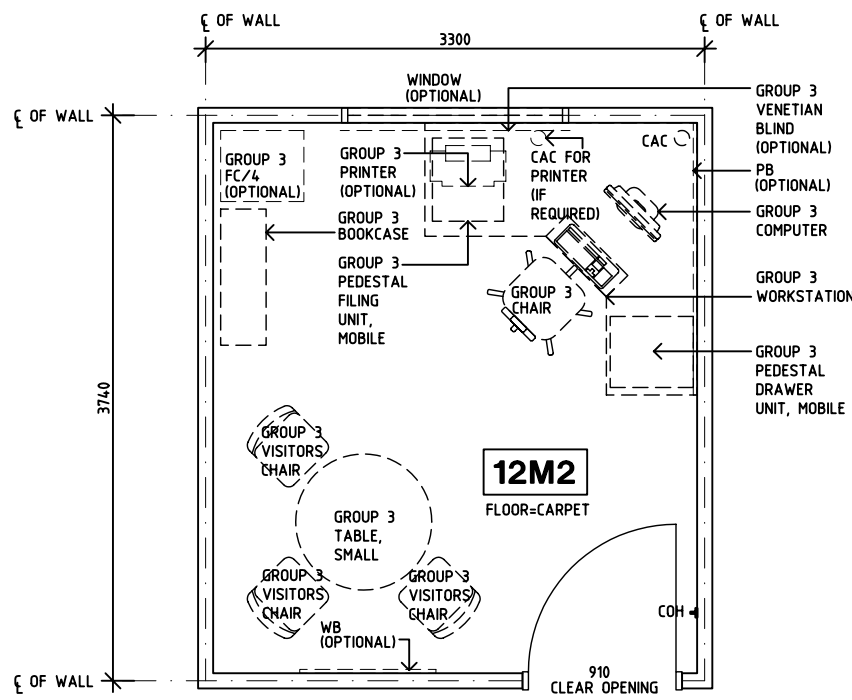

**PLAN**

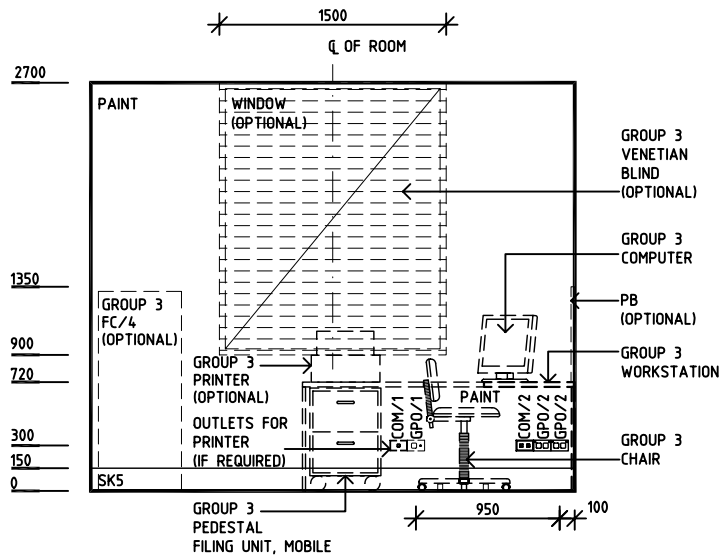

**ELEVATION 1**

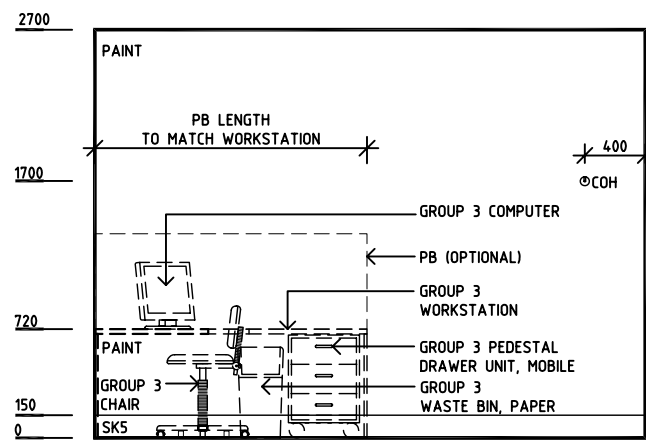

**ELEVATION 2**

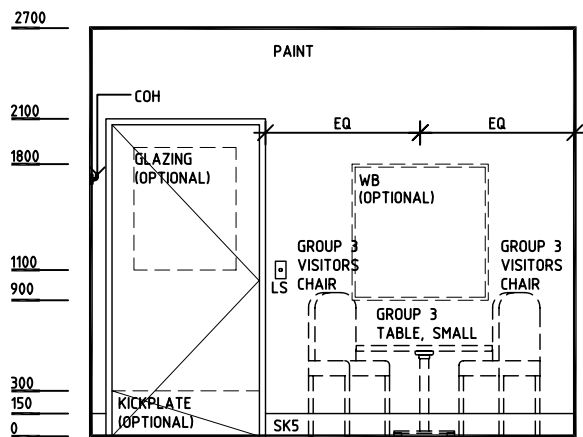

**ELEVATION 3**

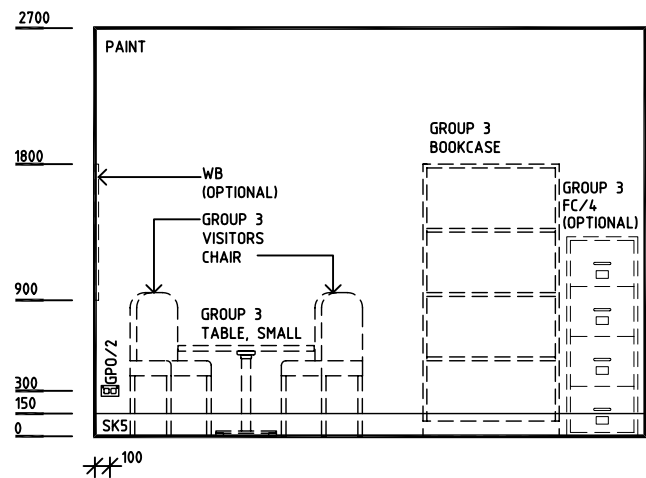

**ELEVATION 4**

REV	DESCRIPTION	DATE	BY	REV	DESCRIPTION	DATE	BY	REV	DESCRIPTION	DATE	BY
1	FIRST ISSUE	8.12.03	AL								
2	GENERAL REVISIONS	26.5.05	HS								